

Versa-Max™

*Repair Clamp & Coupling
Series 3100*



**As a Clamp, as a Coupling, or Both, It's
the Best Available In-Line Repair Product**



Total Piping Solutions, Inc.

®

VERSA-MAX *Series 3100*

**It's a repair clamp, a repair coupling, or both,
in one innovative design!**

The Versa-Max is just the latest in our series of performance-proven products for water and wastewater piping.

The many advantages of the Versa-Max include its ease of installation. You simply open and wrap the fitting around the pipe, like a repair clamp, or leave it in the closed position and stab it on like a coupling. It works both ways. No disassembly is required.

The Versa-Max is also a wide range product. One size per nominal diameter in the 6" and 8" diameters. (Two shell sizes required for most common pipe adaptations in the 3", 4", 10" and 12" nominal diameters). The Versa-Max carries an overall adjustable range of up to 1.26 inches diameter. As you can see, this makes for a lower total installed cost and the opportunity to significantly reduce your investment in inventory.



The design is also lightweight, featuring Type 304 stainless steel, with four easy-to-tighten stainless steel bolts protected with our proprietary Maxi-Lube® anti-seize type plating to prevent galling. Lugs are of a high-impact polycarbonate. Non-glued hydraulic gasket is available in an NSF 61 registered EPDM compound compatible on both drinking water systems and sewerage applications.

VERSA-MAX Series 3100

Materials of Construction: Body/Shell: 304 stainless steel in a unitized 11" wide assembly that allows for one size per nominal diameter in the 6" and 8" diameters. (Two shell sizes required for most common pipe adaptations in the 3", 4", 10" and 12" nominal diameters).

Spanner Plate and Gasket Retention Plate: 304 stainless steel, integral with the shell on a non-welded, light weight design. Retention Plate is Rilsan coated to provide insulation from pipe surfaces.

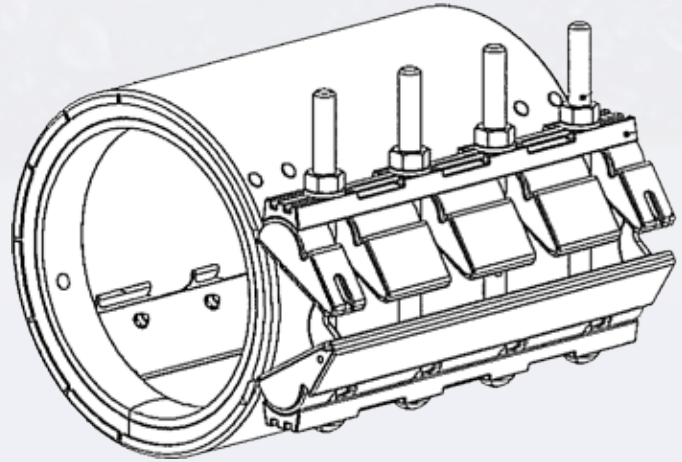

Bolts, Nuts and Washers: 4 easy to tighten (ANSI 304/303) stainless steel protected bolts with our proprietary Maxi-Lube® anti-seize type plating to prevent galling, all rolled threads on bolts, torqued to 50 ft lbs.

Lugs: Polycarbonate, solid core, high impact retainer assembly

Gasketing: Non-glued Hydraulic gasket with full end sealing capability. The gasket is available in an NSF registered EPDM gasket compound for use on drinking water systems and sewerage applications. Each end is an independent sealing element. Temperature range of gasket is -20 to +220° F.

Working/Test Pressure: 3 to 5 inch diameters rated to 232 psi with test pressures to 348 psi
6 to 12 Inch Diameter 175 psi , test to 262 psi
(Meets test requirements of both AWWA C 219 and AWWA C 230)
(Higher working pressure units in the 6 to 12" sizes available upon request)

Standards: Meets AWWA C219-06 for Couplings, and the new Repair Clamp Standard AWWA C230-11

Installation: Open and wrap around the pipe like a repair clamp, or leave in the closed position and stab it on like a coupling. It works both ways. No disassembly required, all bolts stay in place, loosen them up, put fitting on the pipe.

Transition Capability: up to 0.4"

Wide Range: 1.26" of range allows for one size per nominal diameter in the 6" and 8" diameters, and two shell sizes required for the most common pipe adaptations in the 3", 4", 10" and 12" nominal diameters.

Deflectional Capability: 3 degrees per end for a total of 6 degrees across the Versa-Max

VERSA-MAX Series 3100

The Most Versatile Product in the Industry!

Stab it like a coupling
Transition it like a fitting
Wrap it like a clamp

As a Stab Product

Adjust it to size by removing the inner gasket layer on both ends, then stab it on and tighten like any coupling. No disassembly required if using as a stab coupling.

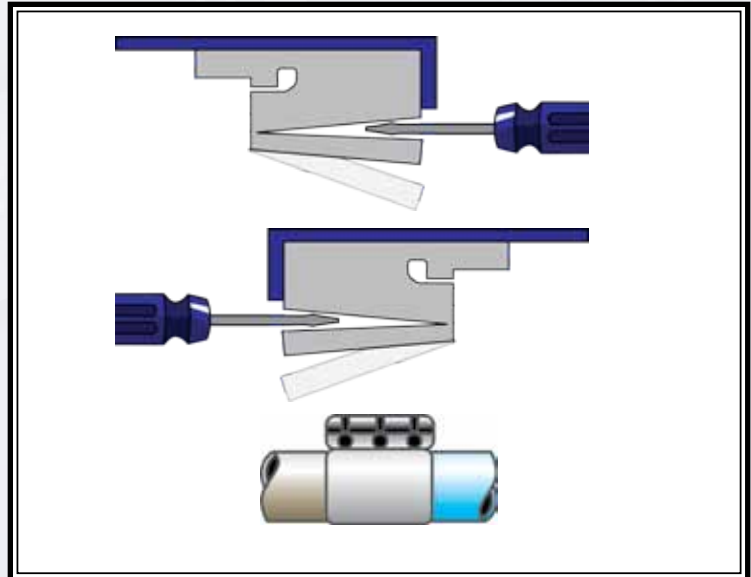

As a Transition Fitting

(Transitions within specified diameter differences for the following pipe material combinations)

DIP to Steel

DIP to PE

DIP to PVC

DIP to CI

DIP to AC150

6"-12" Diameter
Max pipe transition- .4"
diameter difference



3"-5" Diameter
Max pipe transition- .25"
diameter difference



VERSA-MAX Series 3100

As a Super Wide Range Wrap Around Repair Clamp

(allows for up to 3° of Deflection)



3 Degrees

Installing the Versa-Max is as easy as counting to five:

1. Open It



2. Wrap It

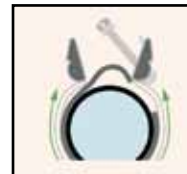

3. Latch It



4. Lock It

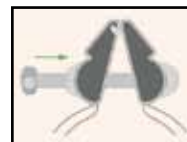

5. Tighten It

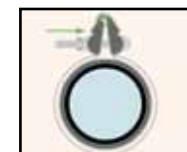

Standard Pressure Versa-Max

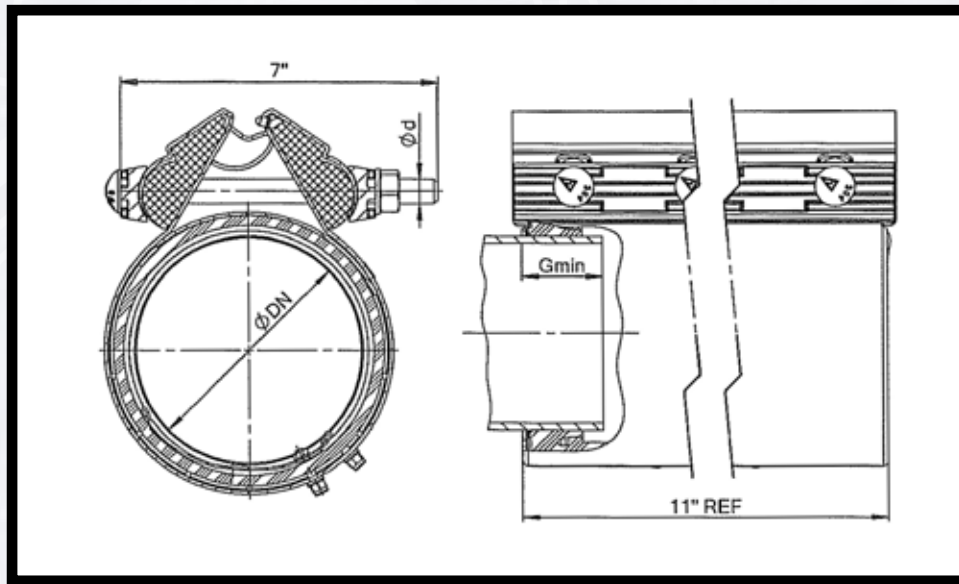

Bolt length in 6" thru 12" sizes is 8.3".

DN (inch)	Overall Range (inch)	Max Stab on Diam. (inch)	Pressure Ratings (psi)	Torque (ft-lbs.)	Approx. Weight (Lbs.)	Bolts Diam. (d)
3"	3.42-4.3	4.2"	232	50	15	M14
4"	4.25-5.15	5.0"	232	50	16.3	M14
4"	4.44-5.35	5.2"	232	50	16.3	M14
4"+5"	4.76-5.67	5.5"	232	50	16.7	M14
5"	5.43-6.3	6.1"	232	50	18.1	M14
5"	5.78-6.65	6.5"	232	50	18.9	M14

DN (inch)	Overall Range (inch)	Before Removal of Inner Layer (inch)	After Removal of Inner Layer (inch)	Max Stab on Diam. Before Removal Of Inner Layer (inch)	Max. Stab on Diameter After Removal of Inner Layer (inch)	Torque (ft-lbs.)	Approx. Weight (Lbs.)	Bolts Diam. (d)
6"	6.42-7.68	6.42-7.12	7.01-7.68	6.9"	7.7"	65	23	M14
7"	7.48-8.74	7.48-8.11	8.07-8.74	7.9"	8.8"	65	24	M14
8"	8.54-9.84	8.54-9.3	9.13-9.84	8.9"	9.8"	65	26	M14
10"u.s.	9.76-11.02	9.76-10.39	10.35-11.02	10.1"	11"	65	26	M14
10"	10.7-12	10.7-11.37	11.33-12	11.2"	12"	80	29	M16
10o.s"	10.96-12.26	10.96-11.63	11.59-12.26	11.5"	12.2"	80	29	M16
12"	12.58-13.84	12.58-13.21	13.15-13.84	13"	13.9"	80	31	M16
12o.s"	13.15-14.41	13.15-13.78	13.74-14.41	13.5"	14.4"	80	33	M16

NOTE: For specific information, dimensions, or special applications on the Versa-Max, consult Total Piping Solutions, Inc.

3" – 5" sizes—single layer gasket. Range is .9", transition capability is .25". 6" – 12" sizes – multi layer gasket. 0.40" transition capability (both gasket layers in place or both gasket inner layers removed.) All sizes are stab coupling with maximum stab diameters as per drawing table above. Deflection 3 degrees per end. Torques per drawing table. Rilsan coated electrically insulated internal gasket spanner plate. Minimum Stab depth on all products is 3 inches.

VERSA-MAX Series 3100

Other Proven Time-Savers from Total Piping Solutions



HYMAX[®] 2000 Coupling

Easy fitting with two bolts total, one to tighten each end, Hymax 2000 coupling is suited to a wide range of pipe joining conditions. Each coupling will replace between three and four modular type couplings in your inventory. Joins pipe with diameter differences up to 1.30 inches. Accommodates angular deflection of up to 8 degrees. Available in sizes from 1.5 to 24 inches in diameter. All sizes are available in either standard or long body lengths.



HYMAX[®] Flanged Adapter

Features same as Hymax 2000 coupling except accommodates angular deflection of up to 4 degrees on the compression end. Stab type fit, no disassembly required. Standard AWWA Class D flange with optional ANSI Class 150.



**Series 2600 HYJOINT[®]
Dismantling Joint**

Suited to a wide range of pipe joining applications that will allow the user to quickly make equipment disconnects and change-outs of valves, pumps, meters and piping assemblies. AWWA Class D spool piece and flange with ANSI 125/150 drilling. AWWA Class D flange and spool piece with flange drilling in compliance with ANSI 125/150. Available in 3" through 24" sizes.



**Series 6000 Long Body
Compression Fittings**

Available in 1/2" thru 2" diameters. Fits steel tubing and PVC pipe (IPS Sizes) With bright electro-galvanic coating. 100 percent air and conductivity tested. 150 psi working pressure. Available with adapter gaskets for copper sizing.



Total Piping Solutions, Inc.
1760 Haskell Road, Olean, New York 14760
TEL: 716-372-0160, FAX: 716-372-1767
E-Mail: sales@tps.us
VISIT OUR WEBSITE: <http://tps.us>



Patented and Trademarked by *Krausz Industries, Ltd.*

NOTE: Bolts/nuts are pre-lubricated with dry coating. Do not field lubricate bolts/nuts. Greasing or field lubricating of bolts/nuts voids warranty. Consult Manufacturer for compatibility of product with fluids other than fresh water or line content other than water. Refer to assembly instructions prior to installing this product. Installation instructions are attached to the product or can be found at www.tps.us. This Versa-Max is a registered patent of Krausz Industries, LTD.

