

A  
2:1

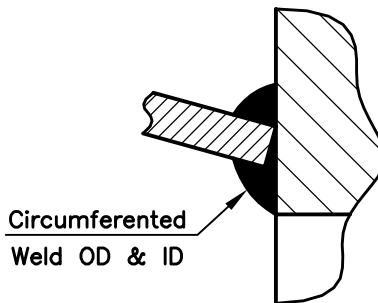

- 1) Hymax 2000 meets or exceeds all specifications of AWWA Standard C219.
- 2) Center Ring – ASTM A 53 Grade A steel.
- 3) End Rings – ASTM A 795 steel.
- 4) Gaskets – EPDM compounded for water and sewerage, meets NSF 61 requirements.
- 5) Bolts and Nuts – Type 304 stainless steel. Rolled thread and anti galling coating.
- 6) Bridge – Type 304 stainless steel.
- 7) Coating – 100% Fusion bonded epoxy for enhanced corrosion protection. Average thickness 14 Mil.
- 8) G = Min. Pipe Insertion of 2.25 inch
- 9) Working Pressure : 175 PSI

ND (mm/inch)	Overall Range (inch)	Before removal the inner layer (inch)	After removal the inner layer (inch)	D1 (inch)	L (inch)	i (inch)	D2 (inch)	B (inch)	d (mm)	Approx. Weight (Lbs)
40/1.5"	1.61–2.13	1.61–1.97	1.96–2.13	ø3.94	5.8	4.1	5.4	ø1.95	M12	7
50/2"	2.10–3.03	2.10–2.60	2.56–3.03	ø5.24	6.0	4.1	6.0	ø2.44	M12	8

Edition	F	Day	Name	Part Name: HYMAX F 2000
	Drawn	14.08.05	S.LORA	
	Check			Drawing No.
	Appr			